

CM16 S

CAN MAN



[WWW.16S.CANMAN.CH](http://WWW.16S.CANMAN.CH)

# CM16 S at a glance

- 1 Fastest format change without timerobbing post adjustments.
- 2 Takes full account of the very latest safety rules.
- 3 Enhanced access for setup, service and operation.
- 4 Open technology for future developments.



## Silentium

Maximum silence during production and maximum access for setup and maintenance. The lift up and down is made by a hydraulic system that ensures a smooth and safe operation.



## SmartCONTROL

A powerful I-PC (industrial PC) in combination with an advanced software eliminates the limits of PLC's (programmable logic controllers) and boosts the handling and monitoring remarkably. Thanks to the built in wireless access point you may watch over your production from wherever you like.

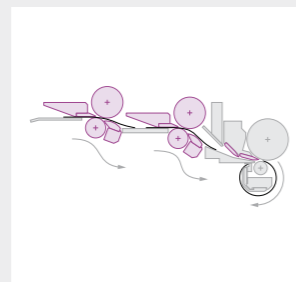

## Doubleflex-Rollformer

With 2 flexer stations we have taken a step to enhance rollforming quality and tackle hardness and thickness variations without additional (and uppricing) technologies.

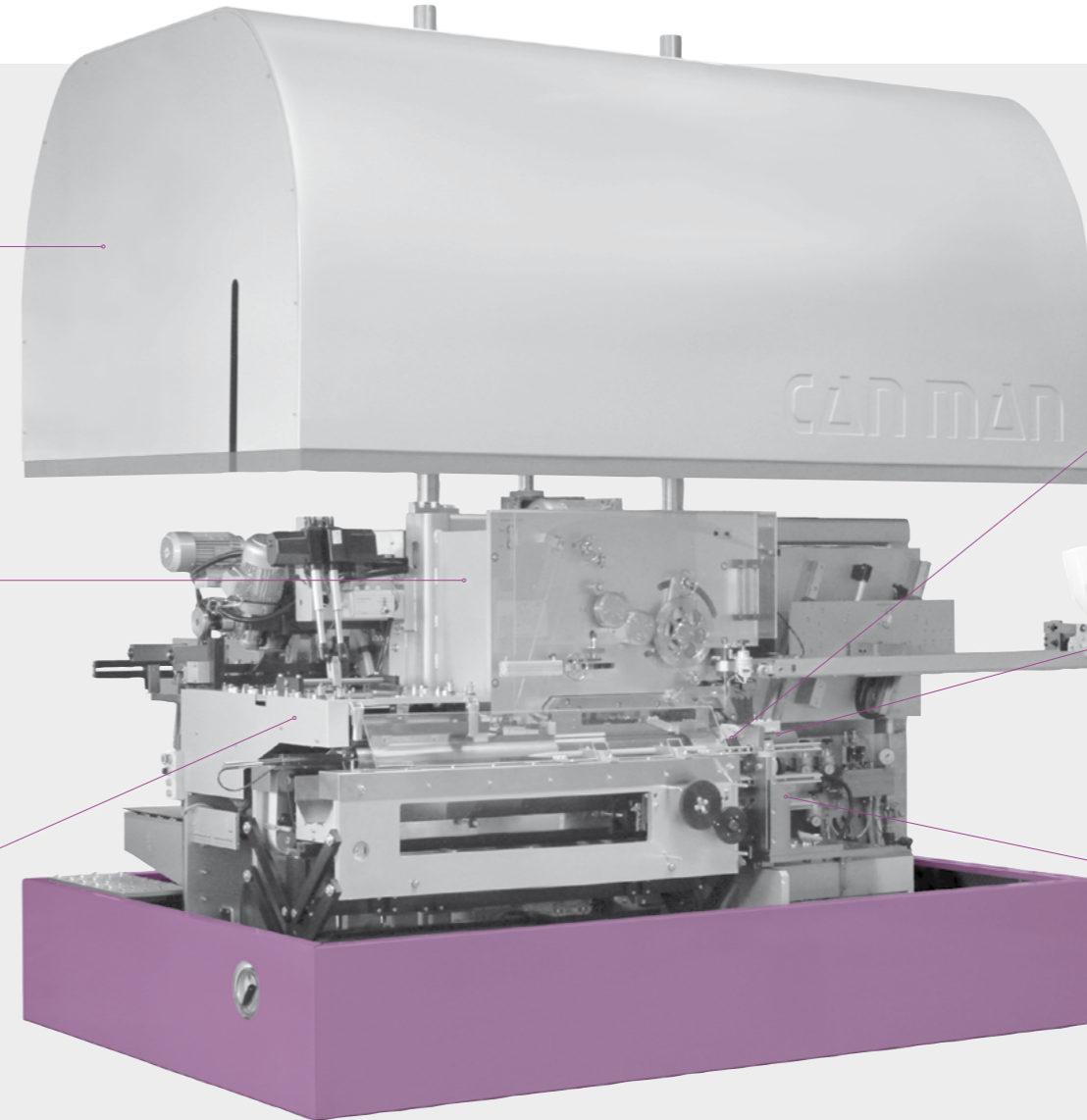

## Qualimaker 2 optional

Complete new wear free running hardware with up to 10'000 measurements/second at max. 4 channels plus the very easy to understand and open SmartCONTROL software bring you a big step closer to a zero-defect production!

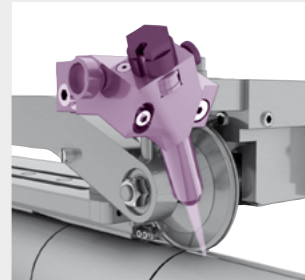

## X-Plane Headpiece

As a standard only 1 instead of 4 items must be adjusted after redressing of the welding roll to achieve a constant welding quality. That means minimal down time and a reduction of human handling errors. Nice side effect: small & cheap nosepiece (z-bar tip).

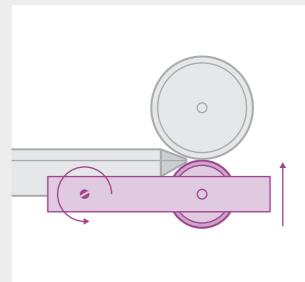

## Swing Out Tool Carriage

Up to 30 kg is the weight of a calibration crown, therefore we have built in a user-friendly tool carriage, which simplifies the change over procedure, protecting your back and giving you a convenient position for tool setup

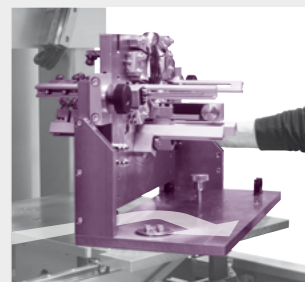

# Technical Data

## Medium Speed Welding Bodymaker

<b>Production output</b>	200/300/400 cans/min, 45/70 meter/min
<b>Body sizes</b>	min. Ø 45 x h 50 mm max. Ø 165 x h 320 mm
<b>Sheet thickness</b>	0.10 - 0.30 mm

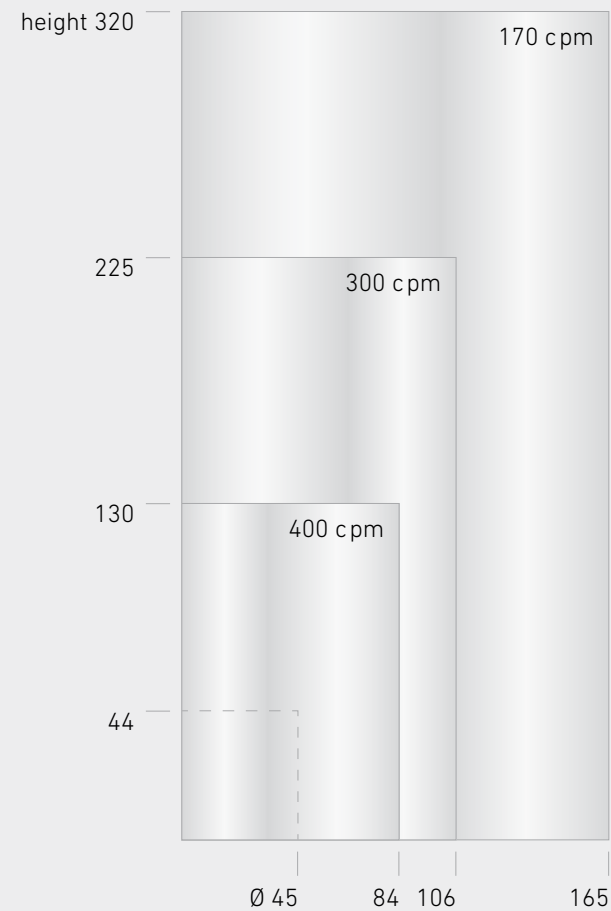

### Can Man AG

Muelisacker 221 T +41 62 777 444 0 sales@canman.ch  
CH-5705 Hallwil F +41 62 777 444 1 [www.canman.ch](http://www.canman.ch)