

X1

CAN MAN

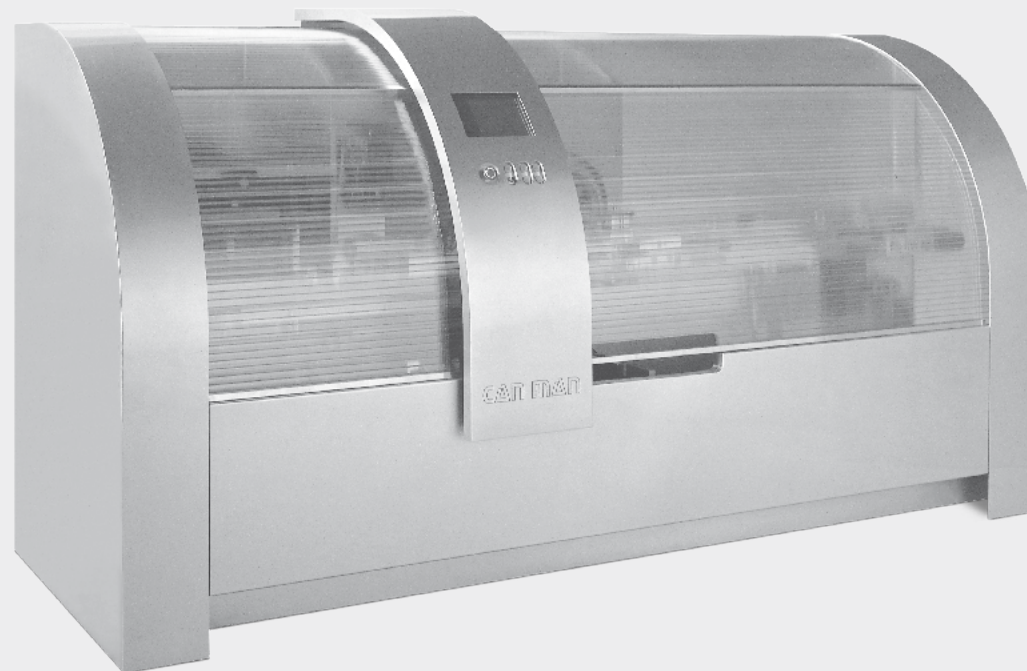

WWW.X1.CANMAN.CH

X1 at a glance

- 1 Easy, fast und safe operation because of smart empowering features.
- 2 Lowest running costs because of the simple design that leads to less wear and tear.
- 3 Highest quality in parts and service for reliable production.
- 4 Most compact WeldCENTER in the market.

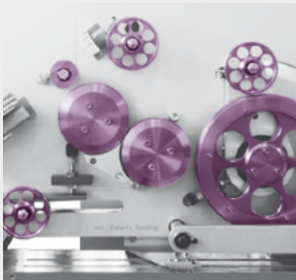

PowerFOIL

The wire diameter reduction from 1.24 or 1.38 mm to 1 mm cuts down copper costs up to 100'000\$ per year. Calculate your individual savings online: www.x1.canman.ch

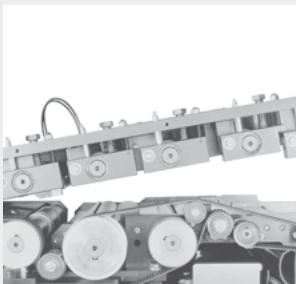

Easy Access

There are no easier to operate welders in the market today than the ones from Can Man. 2 push buttons and you'll fully open the complete flexer rolling unit, lift up the blank magazine, lower the guidance channel, slide aside the body transport system and last but not least unlock and shift forward the calibration tool.

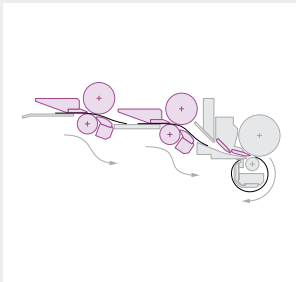

Doubleflex-Rollformer

With 2 flexer stations we have taken a step to enhance rollforming quality and tackle hardness and thickness variations without additional (and uppricing) technologies.



Qualimaker 2

Complete new wear free running hardware with up to 10'000 measurements/second at max. 4 channels plus the very easy to understand and open SmartCONTROL software bring you a big step closer to a zero-defect production!

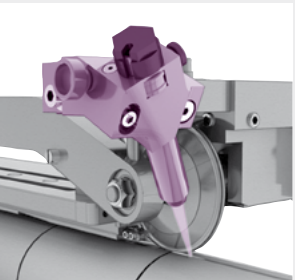

X-Plane Headpiece

Only 1 instead of 4 items must be adjusted after redressing of the welding roll to achieve a constant welding quality. That means minimal down time and a reduction of human handling errors.

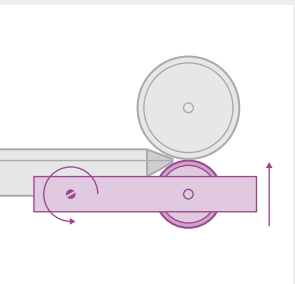

TempGUARD

Can Man's cooling system cools the welder's components when and where it's needed which ensures highest weld quality and protects valuable machine parts from oxidation. Especially in the calibration crown, it is essential to keep a constant temperature throughout the entire tool as thermal stress affects the overlap.



Technical Data

High Speed Welding Bodymaker

Production output	450/550/650 cans/min, 90 meter/min
Body sizes	min. Ø 45 x h 50 mm max. Ø 165 x h 320 mm
Sheet thickness	0.10 - 0.26 mm

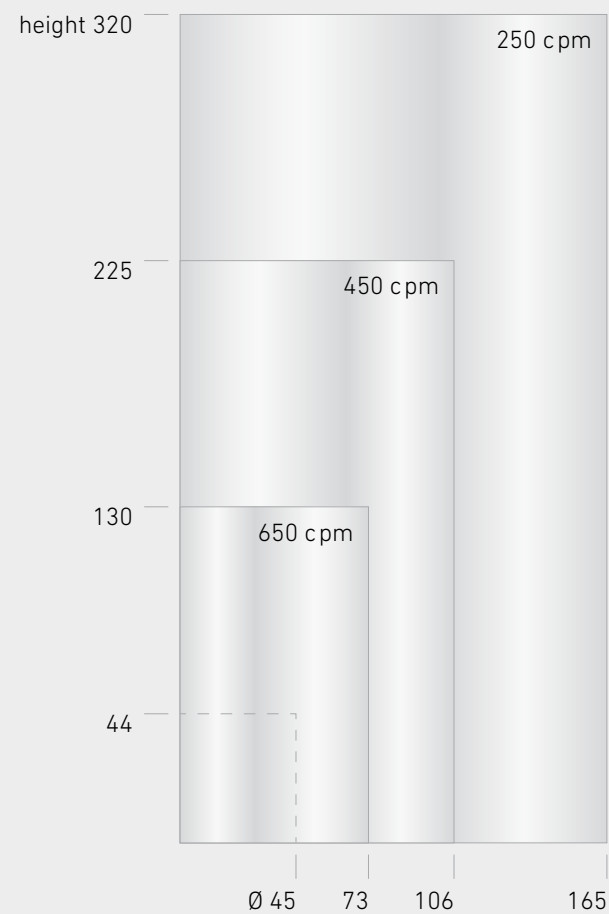

Can Man AG

Muelisacker 221 T +41 62 777 444 0 sales@canman.ch
CH-5705 Hallwil F +41 62 777 444 1 www.canman.ch